

NOTE: ALL MATERIAL COMPLIANT ROHS STANDARD

REVISION INFORMATION			
Rev.	Rev. Date	Modified By	Brief Description

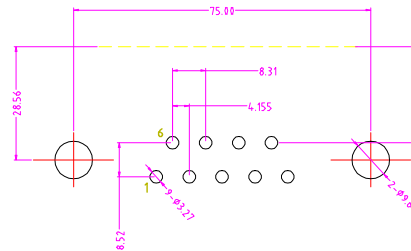

P.C.B LAYOUT

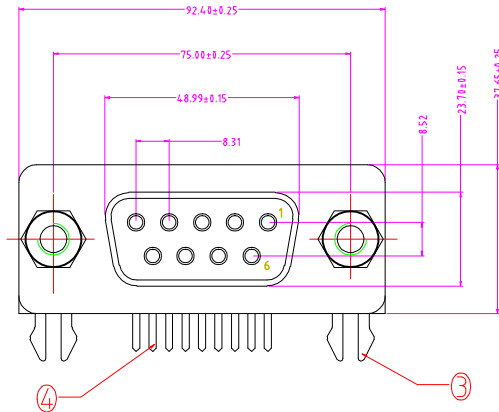
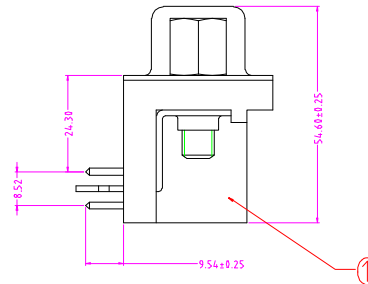
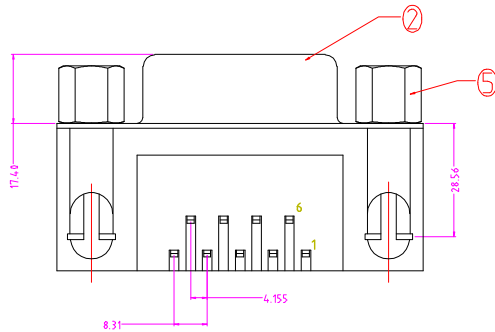
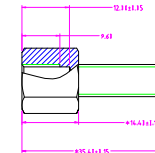
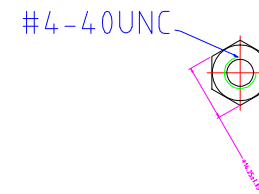

**MATERIAL&FINISH**

Shell: SPCC Material,Nickel Plating

Insulator: P.B.T+30% Glass Fiber(UL94V-0)

Contact Finish: Gold Flash On Contact Area,

Tin Plated On Solder Tail ,under Plated Nickel

Contact Material: Brass

Z flake: SPCC Material, Tin Plating

Screw: 12L14, Nickel Plating

**ELECTRICAL CHARACTERISTICS**

Current Rating: 5amps

Withstanding Voltage: 1000v(one Minute)

Insulation Resistance: 1000mΩ Min.at 500V DC

Operating Temperature: -50℃~+105℃

NO.	PART NAME	DESCRIPTION	PLATING	THICKNESS	Q'TY
5	SCREW	12L14	CU:60U" Ni:80U"		2
4	CONTACT	BRASS(C2680)	Ni:50U", AU:1U" & TIN:100-120U"	0.20mm	9
3	Z FLAKE	SPCC	CU:60U", TIN:80-100U"	0.60mm	2
2	SHELL	SPCC	CU:60U", Ni:80U"	0.35mm	1
1	INSULATOR	PBT+30%G.F UL94V-0(BLACK)			1SET

BestLinkNetware

<b>DRAWN BY</b>	<b>DATE:</b> 2012.11.12	<b>DESCRIPTION:</b> DB9 Female Right Angle Connector
<b>CHECKED BY</b>	<b>SHEET</b> 1 of 1	<b>ITEM NO.</b> 273204
<b>APPROVED BY</b>	<b>SCALE</b> 1:1	<b>REV.</b> 00 <b>UNIT:</b> mm 