

NOTE: ALL MATERIAL COMPLIANT ROHS STANDARD

REVISION INFORMATION			
Rev.	Rev. Date	Modified By	Brief Description

SPECIFICATIONS

1.ELECTRICAL CHARACTERISTICS:

1-1. CONTACT CURRENT RATING:3 AMPERES.

1-2. DIELECTRIC WITHSTANDING VOLTAGE:500 VAC(MIN)
AT SEA LEVEL

1-3. INSULATION RESISTANCE:100 MEGOHMS (MIN)

2. MECHANICAL CHARACTERISTICS:

2-1. CONTACT ENGAGEMENT FORCE: 12 OZ.(MAX)

2-2. CONTACT SEPARATION: 0.75 OZ.(MIN)

2-3. CONTACT RETENTION: 4.41 LB. (MIN)

2-4. CONNECTOR MATING FORCE:3/4 LB.*NO. OF CONTACTS

2-5. OPERATING TEMPERATURE :-55 ° C TO +105 ° C.

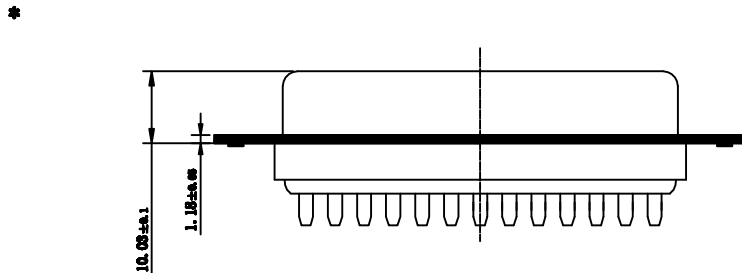
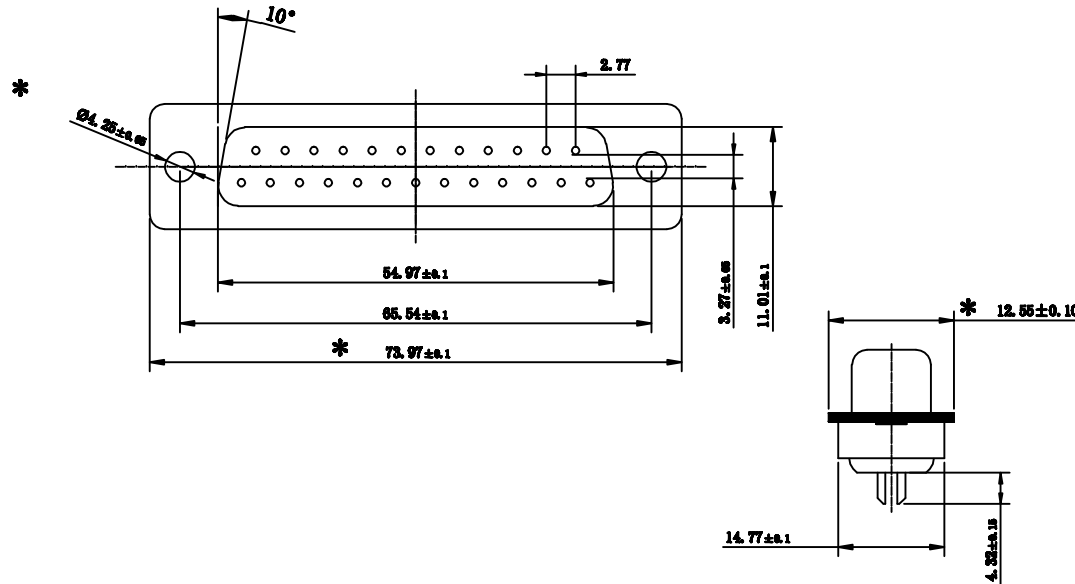

			
DRAWN BY	DATE: 2012/7/6	DESCRIPTION: DB-25F	
CHECKED BY	SHEET 1 of 1	ITEM NO. 273006	
APPROVED BY	SCALE 1:1	REV. 00	UNIT: mm 