

NOTE: ALL MATERIAL COMPLIANT ROHS STANDARD.

**RoHS  
Compliant**

REVISION INFORMATION			
Rev.	Rev. Date	Modified By	Brief Description

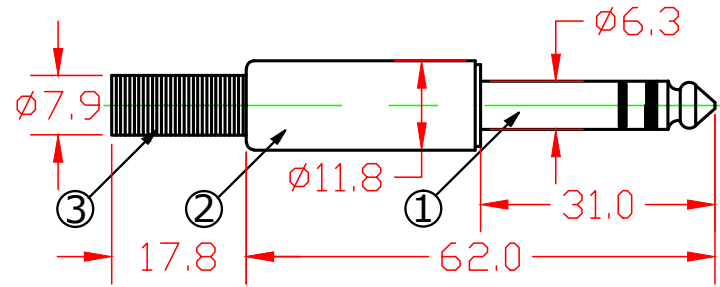

**ELECTRICAL TESTING**  
**1. CONDUCTOR RESISTANCE: ≤5Ω 300V DC**



③	<b>Spring</b>	<b>Metal-Nickel Plated</b>	1	PC
②	<b>Shell</b>	<b>Metal-Nickel Plated</b>	1	PC
①	<b>1/4" MONO Male</b>	<b>6.35 Stereo Male-Nickel Plated</b>	1	PC
NO.	PART NAME	SPECIFICATION DESCRIPTION	Q'TY	UNIT

DRAWN BY	DATE: 2014/04/11	DESCRIPTION: 1/4" 1/4 inch stereo Plug Metal Housing w/ Spring Strain Release
CHECKED BY	SHEET 1 of 1	ITEM NO. <b>201009</b>
APPROVED BY	SCALE 1:1	REV. 00 UNIT: mm